



652 Oliver Street  
 Williamsport, PA 17701 U.S.A.  
 Telephone +1 (800) 258-3279 (U.S. and Canada)  
 Telephone +1 (570) 323-6181 (International)  
 Facsimile +1 (570) 327-7101  
 Email [Technicalsupport@lycoming.com](mailto:Technicalsupport@lycoming.com)  
[www.lycoming.com](http://www.lycoming.com)

# MANDATORY

# SERVICE BULLETIN

DATE: August 29, 2017 Service Bulletin No. 628  
Engineering Aspects are  
FAA Approved

SUBJECT: Reprint of Hartzell Engine Technologies' Service Bulletin ASB 069

MODELS AFFECTED: Table 2 in this Service Bulletin

TIME OF COMPLIANCE: Next maintenance event not to exceed 25 hours or before further flight if fuel leak found during preflight inspection

**NOTICE:** Incomplete review of all the information in this document can cause errors. Read the entire Service Bulletin to make sure you have a complete understanding of the requirements.

This Service Bulletin is notification to remove suspect fuel pumps (Table 1) manufactured by Hartzell Engine Technologies (HET) from specific Lycoming engine models (Table 2) and spares inventories (Table 3) per HET's Service Bulletin SB-069 dated January 25, 2017.

The fuel pumps must be removed from engines and purged from spares inventory because they could have non-conforming diaphragms in the relief valve. The diaphragm is common to all three HET fuel pump series in Table 1.

**Table 1  
Part Numbers for Affected HET Fuel Pump Series**

200F Series	201F Series		202F Series
62E23185	62D26030	62D26034	62E28150
62E23186	62D26031	62D26035	62E18151
62E23187	62D26032	62D26036	
62E23188	62D26033	62D26037	
62E23189			
62E23190			

**NOTICE:** Compliance with this Service Bulletin is mandatory.

**Hartzell Engine Technologies Service Bulletin SB-069 dated January 25, 2017 is reprinted in its entirety as follows and is current at the time Lycoming Service Bulletin No. 628 is issued. However, compliance with this Service Bulletin is to be in accordance with the latest revision of the Hartzell Engine Technologies Service Bulletin SB-069.**

The HET fuel pumps affected by SB 069 include any assemblies manufactured August 14, 2015 through December 5, 2016.

**NOTICE:** Refer to the latest revision of Service Instruction No. 1533 for cross references of HET fuel pump model numbers, Lycoming part numbers, and Lycoming approved applications.



ISSUED			REVISED			PAGE NO.	REVISION
MO	DAY	YEAR	MO	DAY	YEAR		
08	29	17	--	--	--	1 of 27	

Table 2 in this Service Bulletin identifies affected engine models, engine serial numbers, fuel pump part numbers and fuel pump serial numbers that were shipped from Lycoming Engines that have suspect fuel pumps.

Table 3 identifies affected Lycoming part numbers and fuel pump serial numbers of suspect spare fuel pumps shipped from Lycoming.

**Required Action**

1. Identify whether or not you have any of the affected HET fuel pump models in Tables 1, 2 or 3 installed on your Lycoming engine or in inventory.
2. Follow the instructions in the latest revision of HET Service Bulletin SB-069.
3. File a warranty claim directly with HET for replacement of fuel pumps per the Commercial Assistance section in the appendix of the latest revision of HET Service Bulletin SB-069.
4. Record any replacement activity and compliance with this Service Bulletin in the engine logbook.

** WARNING:** WARNING: REFER TO THE INTERNET LINK <http://hartzell.aero/bulletin/?selection=alternators> TO BE SURE YOU HAVE THE LATEST VERSION OF HET’S ALERT SERVICE BULLETIN NO. 069. FAILURE TO COMPLY WITH THIS WARNING COULD CREATE AN UNSAFE CONDITION THAT CAN RESULT IN DEATH, SERIOUS BODILY INJURY, AND/OR PROPERTY DAMAGE.

PROCEDURES IN HET’S BULLETIN MUST BE COMPLETED BY COMPETENT QUALIFIED PERSONNEL FAMILIAR WITH THE SUBJECT ENGINES AND ASSOCIATED AIRFRAMES, SPECIFICALLY THE ENGINE FUEL SYSTEM. FAILURE TO DO SO COULD RESULT IN ECONOMIC LOSS, EQUIPMENT DAMAGE, AND/OR PHYSICAL INJURY.

USE ALL APPLICABLE LYCOMING ENGINES’ MAINTENANCE MANUALS AND/OR SERVICE DOCUMENTS IN CONJUNCTION WITH THIS HET BULLETIN AND THE APPLICABLE AIRFRAME MAINTENANCE MANUAL AND PILOT’S OPERATING HANDBOOK

**Table 2  
Affected Lycoming Engine Models, Engine Serial Numbers,  
Fuel Pump Part Numbers and Fuel Pump Serial Numbers**

Engine Serial Number	Engine Model	Part Number	Component Serial Number ❖
EL-469-79E	AEIO-580-EXP	62E23186	H-TAN016FP
EL-476-79E	AEIO-580-EXP	62E23186	H-TCN004FP
EL-478-79E	YIO-580-EXP18	62E23186	H-TDN005FP
EL-479-79E	YIO-580-EXP18	62E23186	H-TDN044FP
EL-1535-X	YTIO-540-EXP21	62E23187	H-TDN024FP
EL-36677-48E	YIO-540-K1A5	62D26032	H-TFN028FP
L-245-64A	TIO-360-C1A6D	62D26035	H-SJN096FP
L-267-79E	AEIO-580-B1A	62E23186	H-SJN068FP
L-457-79E	AEIO-580-B1A	62E23186	H-SHN014FP
L-458-79E	AEIO-580-B1A	62E23186	H-SIN011FP
L-459-79E	AEIO-580-B1A	62E23186	H-SIN017FP

ISSUED			REVISED			PAGE NO.	REVISION	S.B. 628
MO	DAY	YEAR	MO	DAY	YEAR			
08	29	17	--	--	--	2 of 27		

Engine Serial Number	Engine Model	Part Number	Component Serial Number ❖
L-460-79E	AEIO-580-B1A	62E23186	H-SIN014FP
L-461-79E	IO-580-B1A	62E23186	H-SJN044FP
L-462-79E	IO-580-B1A	62E23186	H-SJN042FP
L-463-79E	AEIO-580-B1A	62E23186	H-SJN069FP
L-464-79E	AEIO-580-B1A	62E23186	H-SKN007FP
L-466-79E	AEIO-580-B1A	62E23186	H-SKN043FP
L-467-79E	AEIO-580-B1A	62E23186	H-SKN033FP
L-468-79E	AEIO-580-B1A	62E23186	H-SKN026FP
L-470-79E	AEIO-580-B1A	62E23186	H-TAN017FP
L-471-79E	AEIO-580-B1A	62E23186	H-TAN021FP
L-472-79E	AEIO-580-B1A	62E23186	H-TBN051FP
L-473-79E	AEIO-580-B1A	62E23186	H-TBN028FP
L-474-79E	AEIO-580-B1A	62E23186	H-TBN027FP
L-475-79E	AEIO-580-B1A	62E23186	H-TBN021FP
L-477-79E	IO-580-B1A	62E23186	H-TDN001FP
L-480-79E	AEIO-580-B1A	62E23186	H-TFN042FP
L-481-79E	AEIO-580-B1A	62E23186	H-TFN041FP
L-482-79E	AEIO-580-B1A	62E23186	H-TFN023FP
L-483-79E	AEIO-580-B1A	62E23186	H-TFN021FP
L-484-79E	AEIO-580-B1A	62E23186	H-TFN024FP
L-485-79E	AEIO-580-B1A	62E23186	H-TFN018FP
L-486-79E	AEIO-580-B1A	62E23186	H-TFN013FP
L-487-79E	AEIO-580-B1A	62E23186	H-TGN067FP
L-488-79E	AEIO-580-B1A	62E23186	H-THN022FP
L-489-79E	AEIO-580-B1A	62E23186	H-THN023FP
L-490-79E	AEIO-580-B1A	62E23186	H-THN037FP
L-491-79E	AEIO-580-B1A	62E23186	H-THN044FP
L-492-79E	AEIO-580-B1A	62E23186	H-TIN009FP
L-1058-68A	LTIO-540-J2BD	62E23186	H-SJN071FP
L-1120-68A	LTIO-540-J2BD	62E23186	H-SJN087FP
L-1125-68A	LTIO-540-J2BD	62E23186	H-SIN012FP
L-1200-68A	LTIO-540-J2B	62E23188	H-SHN007FP
L-1272-68A	LTIO-540-J2B	62E23188	H-TAN024FP
L-1435-68A	LTIO-540-J2BD	62E23186	H-TCN002FP
L-1592-68A	LTIO-540-J2B	62E23188	H-SJN004FP
L-1626-68A	LTIO-540-J2B	62E23188	H-SJN091FP
L-1703-68A	LTIO-540-J2BD	62E23186	H-TBN019FP
L-1800-68A	LTIO-540-J2B	62E23188	H-SJN090FP
L-1812-68A	LTIO-540-J2BD	62E23186	H-THN004FP
L-1975-68A	LTIO-540-J2B	62E23188	H-SJN002FP
L-1978-68A	LTIO-540-J2B	62E23188	H-SHN009FP

ISSUED			REVISED			PAGE NO.	REVISION	S.B. 628
MO	DAY	YEAR	MO	YEAR	3 of 27			
08	29	17	--	--			--	

Engine Serial Number	Engine Model	Part Number	Component Serial Number ❖
L-1999-68A	LTIO-540-J2BD	62E23186	H-SKN031FP
L-2035-48E	IO-540-K1A5	62D26032	H-TAN032FP
L-2117-68A	LTIO-540-J2B	62E23188	H-SHN006FP
L-2193-68A	LTIO-540-J2BD	62E23186	H-SJN048FP
L-2212-68A	LTIO-540-J2B	62E23188	H-SJN092FP
L-2286-68A	LTIO-540-J2B	62E23188	H-SHN008FP
L-2346-68A	LTIO-540-J2BD	62E23186	H-SJN086FP
L-2436-68A	LTIO-540-J2BD	62E23186	H-TFN012FP
L-2939-68A	LTIO-540-J2B	62E23188	H-SHN011FP
L-3023-68A	LTIO-540-J2B	62E23188	H-SHN010FP
L-3024-68A	LTIO-540-J2B	62E23188	H-SJN003FP
L-4317-61A	TIO-540-J2B	62E23186	H-SIN013FP
L-4320-61A	TIO-540-J2B	62E23186	H-SJN041FP
L-6577-61A	TIO-540-J2B	62E23186	H-SJN040FP
L-7434-61A	TIO-540-J2B	62E23186	H-SJN072FP
L-7491-61A	TIO-540-J2B	62E23186	H-SJN051FP
L-9448-61A	TIO-540-J2B	62E23186	H-SJN070FP
L-10052-61A	TIO-540-J2BD	62E23187	H-TDN025FP
L-10116-61A	TIO-540-J2B	62E23186	H-SJN088FP
L-10122-61A	TIO-540-J2B	62E23186	H-SKN027FP
L-10161-61A	TIO-540-C1A	62D26034	H-TBN044FP
L-10180-61A	TIO-540-J2BD	62E23187	H-SKN020FP
L-10187-61A	TIO-540-U2A	62E23186	H-TDM002FP
L-10543-61A	TIO-540-C1A	62D26034	H-TAN006FP
L-10590-61A	TIO-540-A2B	62E23186	H-THN039FP
L-10671-61A	TIO-540-J2BD	62E23187	H-SLN040FP
L-10677-61A	TIO-540-J2BD	62E23187	H-TDN021FP
L-10745-61A	TIO-540-J2B	62E23186	H-SKN032FP
L-10795-61A	TIO-540-S1AD	62E28150	H-TBN036FP
L-10916-61A	TIO-540-J2BD	62E23187	H-TDN023FP
L-10925-61A	TIO-540-J2B	62E23186	H-SKN036FP
L-10943-61A	TIO-540-A2C	62E23186	H-SKN035FP
L-10944-61A	TIO-540-A2C	62E23186	H-SKN037FP
L-11116-61A	TIO-540-J2B	62E23186	H-SKN041FP
L-11168-61A	TIO-540-J2B	62E23186	H-TBN012FP
L-11185-61A	TIO-540-AE2A	62E23186	H-TFN008FP
L-11231-61A	TIO-540-J2BD	62E23187	H-SKN023FP
L-11241-61A	TIO-540-AH1A	62E23186	H-SKN042FP
L-11276-61A	TIO-540-J2B	62E23186	H-TBN018FP
L-11292-61A	TIO-540-J2B	62E23186	H-TGN068FP
L-11294-61A	TIO-540-J2B	62E23186	H-THN041FP

ISSUED			REVISED			PAGE NO.	REVISION	S.B. 628
MO	DAY	YEAR	MO	DAY	YEAR			
08	29	17	--	--	--	4 of 27		

<b>Engine Serial Number</b>	<b>Engine Model</b>	<b>Part Number</b>	<b>Component Serial Number ❖</b>
L-11332-61A	TIO-540-U2A	62E23186	H-THN043FP
L-11333-61A	TIO-540-U2A	62E23186	H-TIN006FP
L-11341-61A	TIO-540-J2B	62E23186	H-SHN012FP
L-11378-61A	TIO-540-J2B	62E23186	H-TFN022FP
L-12843-61E	TIO-540-AJ1A	62E23190	H-TDN066FP
L-13390-61E	TIO-540-AJ1A	62E23190	H-TBN007FP
L-13485-48E	IO-540-K1A5	62D26032	H-SIN028FP
L-14107-48E	IO-540-K1B5	62D26032	H-TGN046FP
L-14218-61E	TIO-540-AJ1A	62E23190	H-SHN003FP
L-14219-61E	TIO-540-AJ1A	62E23190	H-SHN004FP
L-14220-61E	TIO-540-AJ1A	62E23190	H-SHN002FP
L-14221-61E	TIO-540-AJ1A	62E23190	H-SIN006FP
L-14223-61E	TIO-540-AJ1A	62E23190	H-SIN004FP
L-14224-61E	TIO-540-AJ1A	62E23190	H-SIN005FP
L-14225-61E	TIO-540-AJ1A	62E23190	H-SIN008FP
L-14226-61E	TIO-540-AJ1A	62E23190	H-SIN007FP
L-14227-61E	TIO-540-AJ1A	62E23190	H-SIN037FP
L-14229-61A	TIO-540-AE2A	62E23186	H-SIN015FP
L-14230-61E	TIO-540-AJ1A	62E23190	H-SIN038FP
L-14231-61E	TIO-540-AJ1A	62E23190	H-SJN006FP
L-14232-61E	TIO-540-AJ1A	62E23190	H-SJN009FP
L-14233-61E	TIO-540-AJ1A	62E23190	H-SJN005FP
L-14234-61E	TIO-540-AJ1A	62E23190	H-SJN008FP
L-14235-61A	TIO-540-AE2A	62E23186	H-SJN050FP
L-14236-61A	TIO-540-AE2A	62E23186	H-SJN049FP
L-14237-61E	TIO-540-AJ1A	62E23190	H-SJN010FP
L-14238-61E	TIO-540-AJ1A	62E23190	H-SJN012FP
L-14239-61E	TIO-540-AJ1A	62E23190	H-SJN073FP
L-14240-61E	TIO-540-AJ1A	62E23190	H-SJN077FP
L-14241-61E	TIO-540-AJ1A	62E23190	H-SJN076FP
L-14242-61E	TIO-540-AJ1A	62E23190	H-SKN067FP
L-14243-61E	TIO-540-AJ1A	62E23190	H-SKN062FP
L-14244-61E	TIO-540-AJ1A	62E23190	H-SKN068FP
L-14245-61E	TIO-540-AJ1A	62E23190	H-SKN065FP
L-14246-61E	TIO-540-AJ1A	62E23190	H-SKN069FP
L-14247-61E	TIO-540-AJ1A	62E23190	H-SKN064FP
L-14248-61E	TIO-540-AJ1A	62E23190	H-SKN066FP
L-14249-61A	TIO-540-AH1A	62E23186	H-SKN029FP
L-14250-61E	TIO-540-AJ1A	62E23190	H-SLN016FP
L-14251-61E	TIO-540-AJ1A	62E23190	H-SLN037FP
L-14252-61A	TIO-540-AE2A	62E23186	H-TBN010FP

ISSUED			REVISED			PAGE NO.	REVISION	S.B. 628
MO	DAY	YEAR	MO	YEAR	5 of 27			
08	29	17	--	--				

Engine Serial Number	Engine Model	Part Number	Component Serial Number ❖
L-14254-61A	TIO-540-J2B	62E23186	H-TBN014FP
L-14255-61A	TIO-540-AE2A	62E23186	H-TAN022FP
L-14256-61E	TIO-540-AJ1A	62E23190	H-TBN004FP
L-14257-61A	TIO-540-AE2A	62E23186	H-TAN020FP
L-14258-61A	TIO-540-AE2A	62E23186	H-TAN019FP
L-14259-61E	TIO-540-AJ1A	62E23190	H-TAN010FP
L-14260-61A	TIO-540-AE2A	62E23186	H-TBN047FP
L-14261-61A	TIO-540-AE2A	62E23186	H-TBN049FP
L-14262-61E	TIO-540-AJ1A	62E23190	H-TCN025FP
L-14263-61E	TIO-540-AJ1A	62E23190	H-TCN018FP
L-14264-61E	TIO-540-AJ1A	62E23190	H-TCN016FP
L-14265-61E	TIO-540-AJ1A	62E23190	H-TCN023FP
L-14266-61E	TIO-540-AJ1A	62E23190	H-TCN015FP
L-14267-61E	TIO-540-AJ1A	62E23190	H-TCN049FP
L-14268-61E	TIO-540-AJ1A	62E23190	H-TCN051FP
L-14269-61E	TIO-540-AJ1A	62E23190	H-TCN053FP
L-14270-61E	TIO-540-AJ1A	62E23190	H-TCN048FP
L-14271-61E	TIO-540-AJ1A	62E23190	H-TCN050FP
L-14272-61A	TIO-540-AE2A	62E23186	H-TBN053FP
L-14273-61E	TIO-540-AJ1A	62E23190	H-TDN013FP
L-14274-61E	TIO-540-AJ1A	62E23190	H-TDN014FP
L-14275-61A	TIO-540-AE2A	62E23186	H-TBN024FP
L-14276-61E	TIO-540-AJ1A	62E23190	H-TCN052FP
L-14277-61E	TIO-540-AJ1A	62E23190	H-SJN078FP
L-14278-61A	TIO-540-AE2A	62E23186	H-TCN001FP
L-14279-61A	TIO-540-AH1A	62E23186	H-TDN004FP
L-14280-61E	TIO-540-AJ1A	62E23190	H-TCN047FP
L-14281-61E	TIO-540-AJ1A	62E23190	H-SKN060FP
L-14282-61E	TIO-540-AJ1A	62E23190	H-TCN054FP
L-14283-61A	TIO-540-AH1A	62E23186	H-TDN010FP
L-14284-61E	TIO-540-AJ1A	62E23190	H-TDN018FP
L-14285-61A	TIO-540-AE2A	62E23186	H-TDN009FP
L-14286-61A	TIO-540-AE2A	62E23186	H-TDN043FP
L-14287-61A	TIO-540-AE2A	62E23186	H-TDN041FP
L-14288-61A	TIO-540-AE2A	62E23186	H-TDN046FP
L-14289-61A	TIO-540-AE2A	62E23186	H-TFN039FP
L-14290-61A	TIO-540-AE2A	62E23186	H-TFN040FP
L-14291-61E	TIO-540-AJ1A	62E23190	H-TDN019FP
L-14292-61E	TIO-540-AJ1A	62E23190	H-TDN012FP
L-14293-61A	TIO-540-AE2A	62E23186	H-TFN011FP
L-14294-61E	TIO-540-AJ1A	62E23190	H-TDN080FP

ISSUED			REVISED			PAGE NO.	REVISION
MO	DAY	YEAR	MO	DAY	YEAR	6 of 27	S.B. 628
08	29	17	--	--	--		

Engine Serial Number	Engine Model	Part Number	Component Serial Number ❖
L-14295-61E	TIO-540-AJ1A	62E23190	H-TDN081FP
L-14296-61A	TIO-540-AH1A	62E23186	H-TFN025FP
L-14297-61A	TIO-540-AE2A	62E23186	H-TFN017FP
L-14298-61A	TIO-540-J2BD	62E23187	H-TDN020FP
L-14299-61A	TIO-540-J2BD	62E23187	H-TDN022FP
L-14300-61A	TIO-540-AE2A	62E23186	H-TGN071FP
L-14301-61A	TIO-540-AE2A	62E23186	H-TFN007FP
L-14302-61A	TIO-540-AH1A	62E23186	H-TGN066FP
L-14303-61A	TIO-540-AE2A	62E23186	H-TGN073FP
L-14304-61A	TIO-540-AE2A	62E23186	H-TGN070FP
L-14305-61E	TIO-540-AJ1A	62E23190	H-TFN002FP
L-14306-61E	TIO-540-AJ1A	62E23190	H-TFN004FP
L-14307-61A	TIO-540-AE2A	62E23186	H-TGN072FP
L-14308-61E	TIO-540-AJ1A	62E23190	H-TFN036FP
L-14309-61A	TIO-540-AE2A	62E23186	H-THN018FP
L-14310-61A	TIO-540-AE2A	62E23186	H-THN025FP
L-14311-61A	TIO-540-AH1A	62E23186	H-THN024FP
L-14312-61E	TIO-540-AJ1A	62E23190	H-TFN003FP
L-14313-61E	TIO-540-AJ1A	62E23190	H-TFN005FP
L-14314-61E	TIO-540-AJ1A	62E23190	H-TFN037FP
L-14315-61E	TIO-540-AJ1A	62E23190	H-TFN032FP
L-14547-48E	IO-540-K1A5	62D26032	H-TAN031FP
L-17724-48E	IO-540-K1A5	62D26032	H-TCN028FP
L-19112-48E	IO-540-S1A5	62D26034	H-TFN047FP
L-20070-48E	IO-540-M1C5	62D26034	H-SHN056FP
L-20342-48E	IO-540-K1A5	62D26032	H-TEN012FP
L-21335-48E	IO-540-K1A5	62D26032	H-TIN065FP
L-21478-48E	IO-540-K1B5	62D26032	H-TIN068FP
L-21969-48E	IO-540-K1A5	62D26032	H-TDN087FP
L-22152-48E	IO-540-K1A5	62D26032	H-TGN050FP
L-28538-51A	HIO-360-F1AD	62D26035	H-SJN093FP
L-29320-51A	HIO-360-F1AD	62D26035	H-TDN035FP
L-36521-48E	IO-540-K2A5	62D26032	H-SIN029FP
L-36565-48E	AEIO-540-L1B5	62E23186	H-TBN029FP
L-36568-48E	AEIO-540-L1B5	62E23186	H-TCN003FP
L-36623-48E	IO-540-K1A5	62D26032	H-TAN033FP
L-36624-48E	IO-540-K1A5	62D26032	H-TAN034FP
L-36661-48E	IO-540-K1A5	62D26032	H-TEN013FP
L-36664-48E	IO-540-K1A5	62D26032	H-TDN086FP
L-36666-48E	IO-540-K1A5	62D26032	H-TEN010FP
L-36675-48E	IO-540-K1A5	62D26032	H-TFN029FP

ISSUED			REVISED			PAGE NO.	REVISION	S.B. 628
MO	DAY	YEAR	MO	YEAR	7 of 27			
08	29	17	--	--				

Engine Serial Number	Engine Model	Part Number	Component Serial Number ❖
L-36685-48E	IO-540-K1A5	62D26032	H-TFN026FP
L-36691-48E	IO-540-K1A5	62D26032	H-TIN067FP
L-36810-51A	HIO-360-F1AD	62D26035	H-SHN048FP
RL-247-68A	LTIO-540-J2BD	62E23186	H-SHN015FP
RL-465-79E	IO-580-B1A	62E23186	H-SKN010FP
RL-824-68A	LTIO-540-J2BD	62E23186	H-THN021FP
RL-886-68A	LTIO-540-J2BD	62E23186	H-SHN013FP
RL-1019-54A	IO-720-D1C	62E23186	H-TFN006FP
RL-1105-68A	LTIO-540-J2BD	62E23186	H-TBN017FP
RL-1135-61E	TIO-540-AJ1A	62E23190	H-SLN015FP
RL-1291-68A	LTIO-540-J2BD	62E23186	H-TBN016FP
RL-1452-61A	TIO-540-A2B	62E23186	H-TCN005FP
RL-1492-68A	LTIO-540-J2BD	62E23186	H-TBN015FP
RL-1563-68A	LTIO-540-J2B	62E23188	H-TCN006FP
RL-1654-61E	TIO-540-AJ1A	62E23190	H-TBN006FP
RL-1676-68A	LTIO-540-J2BD	62E23186	H-TBN054FP
RL-1810-61E	TIO-540-AJ1A	62E23190	H-TDN017FP
RL-1898-61E	TIO-540-AJ1A	62E23190	H-TBN008FP
RL-1958-68A	LTIO-540-J2BD	62E23186	H-TBN013FP
RL-2180-68A	LTIO-540-J2B	62E23188	H-SJN001FP
RL-2245-68A	LTIO-540-J2B	62E23188	H-SHN005FP
RL-2315-61A	TIO-540-AH1A	62E23186	H-TFN016FP
RL-2332-48E	IO-540-K1A5	62D26032	H-SIN027FP
RL-2985-61E	TIO-540-AJ1A	62E23190	H-TDN058FP
RL-3106-61A	TIO-540-AH1A	62E23186	H-THN040FP
RL-3162-61A	TIO-540-S1AD	62E28150	H-TAN001FP
RL-3184-61A	TIO-540-AE2A	62E23186	H-TBN001FP
RL-3186-61A	TIO-540-J2B	62E23186	H-TFN009FP
RL-3380-61A	TIO-540-J2BD	62E23187	H-SKN021FP
RL-3470-61E	TIO-540-AJ1A	62E23190	H-TBN005FP
RL-3583-61E	TIO-540-AJ1A	62E23190	H-TAN008FP
RL-3733-61A	TIO-540-AK1A	62D26037	H-SIN050FP
RL-3910-61A	TIO-540-J2B	62E23186	H-TFN020FP
RL-4266-51A	HIO-360-F1AD	62D26035	H-SJN094FP
RL-4470-61A	TIO-540-AK1A	62D26037	H-SJN016FP
RL-4575-61A	TIO-540-AH1A	62E23186	H-TIN007FP
RL-4694-61E	TIO-540-AJ1A	62E23190	H-TCN017FP
RL-4710-61A	TIO-540-AE2A	62E23186	H-TDN008FP
RL-4860-61A	TIO-540-AH1A	62E23186	H-TBN030FP
RL-5001-61A	TIO-540-AE2A	62E23186	H-TBN023FP
RL-5068-61E	TIO-540-AJ1A	62E23190	H-TDN065FP

ISSUED			REVISED			PAGE NO.	REVISION
MO	DAY	YEAR	MO	DAY	YEAR	8 of 27	S.B. 628
08	29	17	--	--	--		



Engine Serial Number	Engine Model	Part Number	Component Serial Number ❖
RL-5110-61A	TIO-540-J2BD	62E23187	H-SLN042FP
RL-5157-61A	TIO-540-J2B	62E23186	H-TBN050FP
RL-5157-61E	TIO-540-AJ1A	62E23189	H-TGN075FP
RL-5894-61A	TIO-540-J2B	62E23186	H-TBN026FP
RL-6365-61A	TIO-540-J2B	62E23186	H-TBN025FP
RL-6452-48E	IO-540-K1A5	62D26032	H-TAN030FP
RL-6506-61A	TIO-540-AE2A	62E23186	H-THN019FP
RL-6778-61E	TIO-540-AJ1A	62E23189	H-TGN074FP
RL-7101-61E	TIO-540-AJ1A	62E23190	H-TDN064FP
RL-7153-61E	TIO-540-AJ1A	62E23190	H-SJN007FP
RL-7323-61E	TIO-540-AJ1A	62E23190	H-SJN011FP
RL-7365-61A	TIO-540-AH1A	62E23186	H-SJN045FP
RL-7596-61E	TIO-540-AJ1A	62E23190	H-TFN035FP
RL-7769-48E	IO-540-AA1A5	62E23186	H-TDN042FP
RL-7783-61A	TIO-540-S1AD	62E28150	H-TBN046FP
RL-8554-61A	TIO-540-AE2A	62E23186	H-TBN020FP
RL-8612-61A	TIO-540-J2B	62E23186	H-SJN043FP
RL-8669-61A	TIO-540-AH1A	62E23186	H-TFN014FP
RL-9121-61A	TIO-540-AB1A	62D26036	H-SHN043FP
RL-9301-61E	TIO-540-AJ1A	62E23190	H-SJN013FP
RL-9709-61A	TIO-540-A2C	62E23186	H-SJN067FP
RL-10018-61E	TIO-540-AJ1A	62E23190	H-SJN075FP
RL-10039-48E	IO-540-K1F5	62D26034	H-SHN053FP
RL-10055-61A	TIO-540-AE2A	62E23186	H-TFN015FP
RL-10095-61A	TIO-540-J2B	62E23186	H-TGN069FP
RL-10245-61E	TIO-540-AJ1A	62E23190	H-SJN074FP
RL-10351-61E	TIO-540-AJ1A	62E23190	H-SKN058FP
RL-10358-61E	TIO-540-AJ1A	62E23190	H-TDN016FP
RL-10396-61E	TIO-540-AJ1A	62E23190	H-SKN056FP
RL-10453-61A	TIO-540-J2B	62E23186	H-SKN039FP
RL-10498-61A	TIO-540-AE2A	62E23186	H-SKN008FP
RL-10554-61A	TIO-540-AH1A	62E23186	H-SKN038FP
RL-10618-61A	TIO-540-AF1B	62D26037	H-SIN049FP
RL-10736-61A	TIO-540-AE2A	62E23186	H-SKN009FP
RL-10793-61A	TIO-540-AH1A	62E23186	H-SKN040FP
RL-10797-61E	TIO-540-AJ1A	62E23190	H-SLN038FP
RL-10837-61A	TIO-540-J2B	62E23186	H-SKN034FP
RL-10859-61A	TIO-540-A2C	62E23186	H-TDN011FP
RL-10967-61E	TIO-540-AJ1A	62E23190	H-SHN001FP
RL-10978-61A	TIO-540-J2B	62E23186	H-SKN030FP
RL-11053-61A	TIO-540-AE2A	62E23186	H-SKN028FP

ISSUED			REVISED			PAGE NO.	REVISION	S.B. 628
MO	DAY	YEAR	MO	YEAR	9 of 27			
08	29	17	--	--			--	

Engine Serial Number	Engine Model	Part Number	Component Serial Number ❖
RL-11119-61A	TIO-540-AH1A	62E23186	H-TAN018FP
RL-11717-61A	TIO-540-S1AD	62E28150	H-SJN059FP
RL-12121-61E	TIO-540-AJ1A	62E23190	H-TAN009FP
RL-12202-61E	TIO-540-AJ1A	62E23190	H-SIN001FP
RL-12327-61E	TIO-540-AJ1A	62E23190	H-TBN002FP
RL-12510-61A	TIO-540-AE2A	62E23186	H-SJN046FP
RL-12618-61A	TIO-540-AH1A	62E23186	H-SIN018FP
RL-12789-48E	IO-540-M1C5	62E23186	H-TBN022FP
RL-13155-61A	TIO-540-AK1A	62D26037	H-SIN044FP
RL-16325-48E	IO-540-K1A5	62D26032	H-TCN027FP
RL-17773-48E	IO-540-K1A5	62D26032	H-TAN029FP
RL-17978-48E	IO-540-AA1A5	62E23186	H-SIN019FP
RL-18009-48E	IO-540-K1F5	62D26034	H-SHN055FP
RL-19973-48E	IO-540-S1A5	62D26034	H-SHN054FP
RL-20624-48E	IO-540-K1B5	62D26032	H-TEN011FP
RL-20626-48E	IO-540-K1A5	62D26032	H-TDN088FP
RL-21831-48E	IO-540-K1B5	62D26032	H-TFN030FP
RL-25017-48E	IO-540-K1A5	62D26032	H-SJN034FP
RL-26116-48E	IO-540-K1B5	62D26032	H-SJN026FP
RL-26192-48E	IO-540-K1B5	62D26032	H-SJN029FP
RL-26698-48E	IO-540-K1B5	62D26032	H-SIN030FP
RL-26805-48E	AEIO-540-L1B5D	62D26036	H-SHN038FP
RL-27036-48E	IO-540-K1B5	62D26032	H-SJN025FP
RL-27740-48E	IO-540-K1B5	62D26032	H-SJN037FP
RL-28007-48E	IO-540-M1C5	62E23186	H-SIN016FP
RL-28313-48E	IO-540-K1A5	62D26032	H-SJN031FP
RL-28624-48E	IO-540-K1B5	62D26032	H-TCN029FP
RL-28722-48E	IO-540-K1A5D	62D26035	H-SJN039FP
❖ 1 <sup>st</sup> character “H” – Hartzell 2 <sup>nd</sup> character “S” – 2015 2 <sup>nd</sup> character “T” – 2016 3 <sup>rd</sup> character identifies the month of manufacture with A through L corresponding to January through December (“H” is August, “I” is September, ...).			

ISSUED			REVISED			PAGE NO.	REVISION	S.B. 628
MO	DAY	YEAR	MO	DAY	YEAR			
08	29	17	--	--	--	10 of 27		

**Table 3**  
**Fuel Pump Spare Parts Shipped from Lycoming**

Lycoming Part Number	Component Serial Number	Lycoming Part Number	Component Serial Number	Lycoming Part Number	Component Serial Number
62E23186	H-SKN011FP	62E23190	H-SJN060FP	62E23190	H-TDN076FP
62E23186	H-TBN048FP	62E23190	H-SKN057FP	62E23190	H-TDN077FP
62E23186	H-TBN052FP	62E23190	H-SKN061FP	62E23190	H-TDN078FP
62E23186	H-TDN003FP	62E23190	H-SKN063FP	62E23190	H-TDN079FP
62E23186	H-TDN006FP	62E23190	H-SLN036FP	62E23190	H-TDN082FP
62E23186	H-TDN007FP	62E23190	H-TBN003FP	62E23190	H-TFN033FP
62E23186	H-TDN040FP	62E23190	H-TBN009FP	62E23190	H-TFN034FP
62E23186	H-TDN047FP	62E23190	H-TCN008FP	62E23190	H-TGN003FP
62E23186	H-TFN010FP	62E23190	H-TCN009FP	62D26032	H-SJN027FP
62E23186	H-TFN019FP	62E23190	H-TCN010FP	62D26032	H-SJN028FP
62E23186	H-TFN038FP	62E23190	H-TCN011FP	62D26032	H-SJN030FP
62E23186	H-THN038FP	62E23190	H-TCN012FP	62D26032	H-SJN032FP
62E23186	H-THN045FP	62E23190	H-TCN013FP	62D26032	H-SJN033FP
62E23186	H-TIN082FP	62E23190	H-TCN014FP	62D26032	H-SJN035FP
62E23186	H-TJN072FP	62E23190	H-TCN019FP	62D26032	H-SJN036FP
62E23188	H-TBN033FP	62E23190	H-TCN020FP	62D26032	H-TCN026FP
62E23189	H-SHN018FP	62E23190	H-TCN021FP	62D26032	H-TDN089FP
62E23189	H-SHN019FP	62E23190	H-TCN022FP	62D26032	H-TFN027FP
62E23189	H-SHN020FP	62E23190	H-TCN024FP	62D26032	H-TIN064FP
62E23189	H-SHN021FP	62E23190	H-TDN015FP	62D26032	H-TIN066FP
62E23189	H-TEN002FP	62E23190	H-TDN059FP	62D26035	H-SHN047FP
62E23190	H-SIN002FP	62E23190	H-TDN060FP	62D26035	H-SJN097FP
62E23190	H-SIN003FP	62E23190	H-TDN061FP	62D26035	H-TDN036FP
62E23190	H-SIN009FP	62E23190	H-TDN062FP	62D26036	H-SHN042FP
62E23190	H-SIN010FP	62E23190	H-TDN063FP	62D26036	H-SHN044FP
62E23190	H-SIN039FP	62E23190	H-TDN075FP		

ISSUED			REVISED			PAGE NO.	REVISION	S.B. 628
MO	DAY	YEAR	MO		YEAR			
08	29	17	--	--	--	11 of 27		



2900 Selma Highway  
 Montgomery, AL 36108 USA  
 Tel: 334-386-5400 Fax: 334-386-5450

# Alert Service Bulletin

## Alert Service Bulletin No. 069

### 200F, 201F, 202F Fuel Pump Leak Inspection and Diaphragm Replacement

#### 1. Planning Information

##### A. Effectivity

- (1) Hartzell Engine Technologies LLC (HET) 200F, 201F, 202F Series Fuel Pumps, with HET P/N 063F-0001 diaphragm used in all part number fuel pumps with serial numbers listed below are affected by this Alert Service Bulletin.
  - (a) Fuel pump serial numbers H-QBN029FP, H-QEN146FP, H-QEN147FP, H-QEN148FP, H-SCN031FP and H-SGN069FP through H-TKN090FP are affected by this Alert Service Bulletin. Exceptions to the above serial numbers are listed in Table 1. The affected units may be new or overhauled.
  - (b) Affected HET P/N 063F-0001 diaphragms in inventory or any 200F, 201F, 202F Series Fuel Pump that has been installed and placed in service with an affected diaphragm between August 14, 2015 and December 5, 2016 are affected by this Alert Service Bulletin.
    - \* Engine applications may include but are not limited to those listed in Table 2.

**Table 1: HET 200F, 201F, 202F Series Fuel Pump  
 Serial Number Exceptions (not affected)**

H-SJN004FP	H-SJN014FP	H-SJN015FP	H-SJN017FP	H-SJN018FP	H-SLN039FP	H-SLN041FP	H-TBN032FP
H-TDN070FP	H-TFN026FP	H-TFN029FP	H-TFN031FP	H-TGN004FP	H-TGN020FP	H-TGN049FP	H-TGN050FP
H-THN040FP	H-THN041FP	H-THN042FP	H-TIN008FP	H-TIN010FP	H-TIN011FP	H-TIN012FP	H-TIN013FP
H-TIN015FP	H-TIN016FP	H-TIN017FP	H-TIN067FP	H-TIN081FP	H-TIN083FP	H-TJN001FP	H-TJN002FP
H-TJN003FP	H-TJN004FP	H-TJN006FP	H-TJN007FP	H-TJN008FP	H-TJN009FP	H-TJN033FP	H-TKN007FP
H-TKN008FP	H-TKN009FP	H-TKN010FP	H-TKN011FP	H-TKN012FP	H-TKN013FP	H-TKN014FP	- END -

**WARNING:** DO NOT USE OBSOLETE OR OUTDATED INFORMATION. PERFORM ALL INSPECTIONS OR WORK IN ACCORDANCE WITH THE MOST RECENT REVISION OF THIS ALERT SERVICE BULLETIN. INFORMATION CONTAINED HEREIN MAY BE SIGNIFICANTLY CHANGED FROM EARLIER REVISIONS. FAILURE TO COMPLY WITH THIS ALERT SERVICE BULLETIN OR THE USE OF OBSOLETE INFORMATION MAY CREATE AN UNSAFE CONDITION THAT MAY RESULT IN DEATH, SERIOUS BODILY INJURY, AND/OR SUBSTANTIAL PROPERTY DAMAGE. REFER TO THE HET WEBSITE WWW.HARTZELL.AERO FOR THE MOST RECENT REVISION LEVEL OF THIS ALERT SERVICE BULLETIN.

##### B. Concurrent Requirements

- (1) None

##### C. Reason

- (1) Fuel leakage through the fuel pump diaphragm has been observed. This condition may be due to a manufacturing condition allowing the diaphragm to crack or tear.
- (2) Replacement of the diaphragm is required for the affected 200F, 201F, 202F series fuel pump.
- (3) Regulatory action is unknown.

ISSUED			REVISED			PAGE NO.	REVISION	S.B. 628
MO	DAY	YEAR	MO	DAY	YEAR	12 of 27		
08	29	17	--	--	--			

# Alert Service Bulletin

## Alert Service Bulletin No. 069

### 200F, 201F, 202F Fuel Pump Leak Inspection and Diaphragm Replacement

#### D. Description

- (1) This Alert Service Bulletin provides Instructions for Continued Airworthiness (ICA).
- (2) This Alert Service Bulletin provides instructions for repair of an affected fuel pump by installation of a new HET P/N 063F-0001 diaphragm or the replacement of the fuel pump with one not affected by this Alert Service Bulletin.

#### E. Compliance

- (1) Within twenty-five (25) hours time in service or at the next regularly scheduled inspection, whichever occurs first, inspect the affected fuel pump reference vent port for fuel leakage in accordance with the Accomplishment Instructions of this Alert Service Bulletin.
  - (a) If fuel leakage at the fuel pump reference port IS found, the affected fuel pump must be repaired by installation of a new diaphragm, or the affected fuel pump must be replaced with one not affected by this Alert Service Bulletin prior to next flight.
  - (b) If fuel leakage at the fuel pump reference port IS NOT found, repeat inspection each twenty-five (25) hours time in service thereafter, not to exceed twelve (12) calendar months from the effective date of this publication or until the affected fuel pump can be repaired or replaced with fuel pump not affected by this Alert Service Bulletin.
- (2) Repair or replacement of an affected fuel pump in accordance with the Accomplishment Instructions is the terminating action for this Alert Service Bulletin.

#### F. Approval

- (1) FAA acceptance has been obtained on technical data in this publication that affects type design.

#### G. Manpower

- (1) Labor is negligible for identification and inspection when performed in conjunction with regularly scheduled maintenance required by the engine/aircraft manufacturer.
- (2) Up to one and a half (1.5) hours labor required for removal and installation of the fuel pump.
- (3) If a fuel pump cooling shroud is installed, up to an additional one (1.0) hour labor is required for removal and installation of the fuel pump cooling shroud.
- (4) Up to one (1.0) hour labor is required for replacement of the pump diaphragm and Return to Service if performed in conjunction with regularly scheduled maintenance.

#### H. References

- (1) Applicable aircraft POH or AFM.
- (2) Aircraft maintenance manual (as applicable).
- (3) Engine Service Instructions or maintenance manual (as applicable).
- (4) HET Fuel Pump Overhaul Manual, P/N 200201-0000 Rev. H or latest revision.

#### I. Other Publications Affected

- (1) None

#### J. Weight and Balance

- (1) No Change

ISSUED			REVISED			PAGE NO.	REVISION	S.B. 628
MO	DAY	YEAR	MO		YEAR	13 of 27		
08	29	17	--	--	--			

# Alert Service Bulletin

## Alert Service Bulletin No. 069

### 200F, 201F, 202F Fuel Pump Leak Inspection and Diaphragm Replacement

#### 2. Material Required

- A. If replacing the fuel pump, one (1) each, fuel pump of the part number removed that is not affected by this Alert Service Bulletin. - OR -

If repairing the fuel pump:

- (1) One (1) each, Diaphragm, HET P/N 063F-0001.
- (2) Four (4) each, Cap Screw, P/N NAS1352C3H20.
- (3) Four (4) each, Washer, HET P/N 065F-0003.

- B. Appropriate length of 0.032 inch stainless steel safety wire -or- optional use: Two (2) each, Safe-T-Cable™, HET P/N RX-1961.

#### 3. Accomplishment Instructions

**WARNING:** THIS PROCEDURE MUST BE PERFORMED BY COMPETENT AND QUALIFIED PERSONNEL WHO ARE FAMILIAR WITH ENGINE AND AIRFRAME MAINTENANCE THAT IS SPECIFIC TO THE ENGINE FUEL SYSTEM. FAILURE TO DO SO MAY RESULT IN ECONOMIC LOSS, EQUIPMENT DAMAGE, AND/OR PHYSICAL INJURY.

**CAUTION 1:** DO NOT USE OBSOLETE OR OUTDATED INFORMATION. PERFORM ALL INSPECTIONS OR WORK IN ACCORDANCE WITH THE MOST RECENT REVISION OF THIS ALERT SERVICE BULLETIN AND THE APPLICABLE AIRCRAFT, ENGINE AND/OR THE HET P/N 200201-0000 MAINTENANCE MANUAL. INFORMATION CONTAINED IN THESE MANUALS OR THIS ALERT SERVICE BULLETIN MAY BE SIGNIFICANTLY CHANGED FROM EARLIER REVISIONS. FAILURE TO COMPLY WITH THE ALERT SERVICE BULLETIN OR THE USE OF OBSOLETE INFORMATION MAY CREATE AN UNSAFE CONDITION THAT MAY RESULT IN DEATH, SERIOUS BODILY INJURY, AND/OR SUBSTANTIAL PROPERTY DAMAGE. REFER TO THE HET WEBSITE (WWW.HARTZELL.AERO) FOR THE MOST RECENT REVISION OF THE 200201-0000 MANUAL.

**CAUTION 2:** DO NOT DEPEND ON THIS ALERT SERVICE BULLETIN FOR GAINING ACCESS TO THE ENGINE OR FUEL PUMP. ACCESS REQUIRES THE USE OF THE APPLICABLE MANUFACTURER'S MAINTENANCE MANUALS OR SERVICE INSTRUCTIONS. IN ADDITION, ANY PREFLIGHT OR IN FLIGHT OPERATIONAL CHECKS REQUIRE USE OF THE APPROPRIATE AFM OR POH.

#### A. Fuel Pump Identification

- (1) If positive identification of the fuel pump model and serial number can be made through the engine or aircraft documentation, and the fuel pump is affected per 1.A, continue to 3.B Inspection. If the fuel pump is NOT affected, no further action is required.
- (2) Identify any 200F, 201F, 202F Series Fuel Pump that has field installed an affected HET P/N 063F-0001 diaphragm between August 14, 2015 and December 5, 2016 through the engine or aircraft documentation and if the fuel pump is affected per 1.A(1)b, continue to 3.B Inspection.
  - (a) If records do not indicate that an affected HET P/N 063F-0001 diaphragm was field installed, the fuel pump is NOT affected and no further action is required.
- (3) If positive identification cannot be made through engine or aircraft documentation, gain access and locate the data tag on the fuel pump to verify the fuel pump effectivity.
  - (a) If the unit IS affected, proceed to section 3.B Inspection.
  - (b) If the unit IS NOT affected, return any components that were required to gain access. No further action required.

Rev. New: January 25/17

© 2017 - Hartzell Engine Technologies. - All rights reserved

ASB 069  
Page 3 of 12

ISSUED			REVISED			PAGE NO.	REVISION	S.B. 628
MO	DAY	YEAR	MO	DAY	YEAR			
08	29	17	--	--	--	14 of 27		

# Alert Service Bulletin Appendix

Alert Service Bulletin No. 069

## 200F, 201F, 202F Fuel Pump Leak Inspection and Diaphragm Replacement

### 6. SERVICE FACILITIES:

- A. The following service facilities have the capability of servicing the HET P/N 200F, 201F, and 202F fuel pumps and may provide a method of compliance with this Alert Service Bulletin.

#### **Aero Recip**

540 Marjorie Street  
Winnipeg, Manitoba R3H 0S9  
CANADA  
Phone: +1.800.561.5541  
Email: info@aerorecip.com

#### **Aircraft Accessories of Oklahoma**

2740 N. Sheridan Rd.  
Tulsa, Oklahoma 74115  
Phone: 800.255.9924  
Email: airacc1@airacc.com

#### **AMETEK B&S Aircraft Parts & Accessories**

1414 South Mosley  
Wichita, KS 67211  
Phone: +1.316.264.2397  
Web Site: www.bsaircraft.com  
Email: sales.bsaircraft@ametek.com

#### **Nicholson McLaren**

12 Ivanhoe Road  
Hogwood Industrial Estate  
WOKINGHAM Berkshire RG40 4QQ  
United Kingdom  
Phone: +44.(0)118.973.8000  
Email: aviation.sales@n-mclaren.co.uk

#### **Professional Aircraft Accessories, Inc.**

14 East Main Street  
Amelia, OH 45102  
Phone: +1.513.732.3361  
Fax: +1.513.752.1332  
Email: mlg188@aol.com

#### **Quality Aircraft Accessories, Inc.**

5746 Apache St.  
Tulsa, OK 74115  
Phone: 877.833.6948  
Email: sales@qaa.com

ISSUED			REVISED			PAGE NO.	REVISION	S.B. 628
MO	DAY	YEAR	MO		YEAR	15 of 27		
08	29	17	--	--	--			

# Alert Service Bulletin Appendix

Alert Service Bulletin No. 069

## 200F, 201F, 202F Fuel Pump Leak Inspection and Diaphragm Replacement

### 3. COMMERCIAL ASSISTANCE ADMINISTRATION:

- A. Complete the Alert Service Bulletin ASB 069 Claim Form attached to this appendix.
  - (1) Mail, e-mail, or fax the ASB 069 Claim Form to the attention of Product Support as indicated on the Alert Service Bulletin Claim Form.
- B. Upon receipt of the Alert Service Bulletin Claim Form, HET will:
  - (1) If required by the Alert Service Bulletin, ship the material required by section 2.A and 2.B, to the service provider indicated.
  - (2) The service provider must return proof of service within thirty (30) days or the service provider shall be invoiced for the HET supplied materials.
- C. For labor and material charges:
  - (1) Aircraft/engine service facility must submit an invoice up to the amount specified in section 2, copies of logbook entries, and a completed ASB 069 Claim Form for reimbursement.

### 4. WARRANTY STATEMENT:

- A. The sole warranty for the actions of ASB 069 are contained in the HET Limited Warranty Policy issued with the purchase of each new/overhauled fuel pumps (see terms and conditions therein).
- B. Commercial assistance may apply as stated in this Appendix.
- C. Issuance of ASB 069 in no way constitutes an implied or expressed warranty of any kind.
- D. This publication does not imply or state any responsibility for the workmanship of any person or entity performing work or maintenance on the engine or aircraft fuel system.

### 5. CONTACT INFORMATION:

- A. Contact **HET Product Support** for all communications regarding the technical content of this Alert Service Bulletin.
  - (1) Phone +1.334.386.5400 (Option 2)
  - (2) Fax +1.334.386.5450.
  - (3) E-mail at techsupport@HartzellEngineTech.com.
  - (4) Address  
Hartzell Engine Technologies LLC  
2900 Selma Highway,  
Montgomery, AL 36108  
USA

(A list of fuel pump repair facilities is shown on the next page.)

ISSUED			REVISED			PAGE NO.	REVISION	S.B. 628
MO	DAY	YEAR	MO	DAY	YEAR	16 of 27		
08	29	17	--	--	--			



# Alert Service Bulletin Appendix

Alert Service Bulletin No. 069

## 200F, 201F, 202F Fuel Pump Leak Inspection and Diaphragm Replacement

### 1. ELIGIBILITY:

- A. Hartzell Engine Technologies LLC (HET) 200F, 201F, 202F Series Fuel Pumps, all P/N's with S/N's as shown below are eligible:
  - (1) Serial number fuel pumps H-QBN029FP, H-QEN146FP, H-QEN147FP, H-QEN148FP, H-SCN031FP and H-SGN069FP through H-TJN090FP.
  - (2) Serial number fuel pumps listed in Table 1- "Exceptions" are not eligible.
- B. Any affected diaphragm in inventory or any 200F, 201F, 202F Series Fuel Pump that has been installed and placed in service with an affected diaphragm between August 14, 2015 and December 1, 2016.

### 2. COMMERCIAL ASSISTANCE PROGRAM:

The following will be provided with the submission of a completed ASB 069 Claim Form, copies of invoices showing breakdown of material and labor charges, and log book entries. **Any commercial assistance or other consideration shall expire twelve (12) calendar months from the original published date of Alert Service Bulletin No. 069.**

- A. Initial Inspection
  - (1) One half (0.5) hour labor to gain access to the pump and perform inspection paid at a shop rate of up to \$75 per hour. If a fuel pump cooling shroud is installed, up to an additional one (1.0) hour labor will be provided for removal and installation of the fuel pump cooling shroud.
- B. Pump Repair or Replacement
  - (1) For field replacement of the diaphragm in an eligible fuel pump (refer to Appendix section 6 for a listing of potential service facilities) HET will provide:
    - (a) Materials Required in ASB 069 section 2.
    - (b) Labor for Corrective Action for affected fuel pumps will be paid at a shop rate of \$75 per hour up to the amount specified below:
      - (i) one (1.0) hour labor to replace the fuel pump diaphragm
      - (ii) Up to one and a half (1.5) hours labor for removal and installation of the fuel pump. If a fuel pump cooling shroud is installed, up to an additional one (1.0) hour labor will be provided for removal and installation of the fuel pump cooling shroud.
  - (2) If returning an eligible fuel pump, HET will repair and return the unit.
    - (a) Customer **must** obtain an **RMA approval number** from HET **before** returning the fuel pump to HET for factory repair.
    - (b) Up to one and a half (1.5) hours labor for removal and installation of the fuel pump. If a fuel pump cooling shroud is installed, up to an additional one (1.0) hour labor will be provided for removal and installation of the fuel pump cooling shroud.

ISSUED			REVISED			PAGE NO.	REVISION	S.B. 628
MO	DAY	YEAR	MO		YEAR	17 of 27		
08	29	17	--	--	--			

# Alert Service Bulletin

Alert Service Bulletin No. 069

**200F, 201F, 202F Fuel Pump Leak Inspection and Diaphragm Replacement**

INTENTIONALLY LEFT BLANK

ISSUED			REVISED			PAGE NO.	REVISION	S.B. 628
MO	DAY	YEAR	MO	DAY	YEAR	18 of 27		
08	29	17	--	--	--			

# Alert Service Bulletin

## Alert Service Bulletin No. 069

### 200F, 201F, 202F Fuel Pump Leak Inspection and Diaphragm Replacement

**Table 2 (cont'd) - Engine Application & Cross Reference\***

Part Number HET Fuel Pump	Part Number Lycoming (Ref. Only)	Lycoming Engine Installation Eligibility
201F-5001	62D26030	IO-540-G1B5; IO-540-G1D5; IO-540-J4A5; IO-540-R1A5; IO-720-A1A; IO-720-A1B
201F-5002	62D26031	IO-720-A1A; IO-720-A1B
201F-5003	62D26032	IO-540-G1C5; IO-540-K1A5; IO-540-K1B5; IO-540-K1F5; IO-320-C1A; IO-320-F1A
201F-5004	62D26033	IO-360-A1B; TIO-360-A1B
201F-5005	62D26034	IO-540-A1A5; IO-540-G1B5; IO-540-G1D5; IO-540-K1C5; IO-540-K1D5; IO-540-K1F5; IO-540-L1A5; IO-540-P1A5; IO-360-B1D; TIO-540-A2B; TIO-540-C1A; TIO-540-E1A; TIO-540-G1A; TIO-540-H1A
201F-5006	62D26035	IO-540-K1A5D; TIO-360-C1A6D; LIO-320-C1A
201F-5007	62D26036	IO-540-M2A5D; TIO-540-AA1AD; TIO-540-AB1AD
201F-5008	62D26037	TIO-540-AF1A; TIO-540-AF1B

\* The information in Table 2 is provided for reference only. The applicable engine manufacturer's Type Certification information should be consulted as the official source.

**NOTE:** 200F Fuel Pump P/N 200F-5006 (Lycoming P/N 62E23190) and P/N 200F-5007 (Lycoming P/N 62E23191-Y) are a Lycoming installation. Application information for these fuel pumps must be obtained from Lycoming.

ISSUED			REVISED			PAGE NO.	REVISION	S.B. 628
MO	DAY	YEAR	MO		YEAR	19 of 27		
08	29	17	--	--	--			

# Alert Service Bulletin

**Alert Service Bulletin No. 069**

## 200F, 201F, 202F Fuel Pump Leak Inspection and Diaphragm Replacement

**Table 2 - Engine Application & Cross Reference\***

Part Number HET Fuel Pump	Part Number Lycoming (Ref. Only)	Lycoming Engine Installation Eligibility
200F-5001	62E23185	GO-435; GO-435-C2; GO-435-C2A; GO-435-C2A2; GO-435-C2B; GO-435-C2B1; GO-435-C2B2; GO-435-C2C; GO-435-C2D; GO-435-C2E; GO-435-D1; GO-480; GO-480-A1A; GO-480-B; GO-480-B1; GO-480-B1A6; GO-480-B1D; GO-480-C1D6; GO-480-C2C6; GO-480-C2D6; GO-480-C2E6; GO-480-C3A6; GO-480-E1A6; GO-480-F6; GO-480-F1A6; GO-480-F2A6; GO-480-F2D6; GO-480-F3A6; GO-480-F3B6; GO-480-F4A6; GO-480-F4B6; GO-480-G1A6; GO-480-G1D6; GO-480-G1H6; GO-480-G1J6; GO-480-G2D6; GO-480-G2F6
200F-5002	62E23186	IO-540-K1E5; IO-720-A1A; IO-720-A1B; IO-720-B1B; IO-720-C1B; IO-720-D1B; LTIO-540-F2BD; LTIO-540-J2BD; TIGO-541-D1A; TIGO-541-D1B; TIGO-541-E1A; TIO-360-A3B6; TIO-540-A1A; TIO-540-A1B; TIO-540-A2A; TIO-540-A2B; TIO-540-A2C; TIO-540-AE2A; TIO-540-J2B; TIO-540-U2A;
200F-5003	62E23188	TIO-540-AB1AD; TIO-540-AA1AD; LTIO-540-U2A; LTIO-540-J2B
200F-5004	62E23187	IO-540-K1F5D; LTIO-540-W2A; TIO-540-F2BD; TIO-540-J2BD; TIO-540-N2BD; TIO-540-R2AD; TIO-540-T2AD; TIO-540-V2AD
200F-5005	62E23189	IO-720-A1B; LTIO-540-V2AD; TIO-540-W2A; TIO-540-AH1A; TIO-540-AJ1A
202F-1001	62E22586  Beechcraft P/N 50-389141-1	AEIO-540-D4D5  56TC; A56TC;60; A60; & B60
202F-1002	62E22585 / LW-19012	TIO-540-S1AD

\* The information in Table 2 is provided for reference only. The applicable engine manufacturer's Type Certification information should be consulted as the official source.

ISSUED			REVISED			PAGE NO.	REVISION	S.B. 628
MO	DAY	YEAR	MO	DAY	YEAR			
08	29	17	--	--	--	20 of 27		

# Alert Service Bulletin

Alert Service Bulletin No. 069

200F, 201F, 202F Fuel Pump Leak Inspection and Diaphragm Replacement

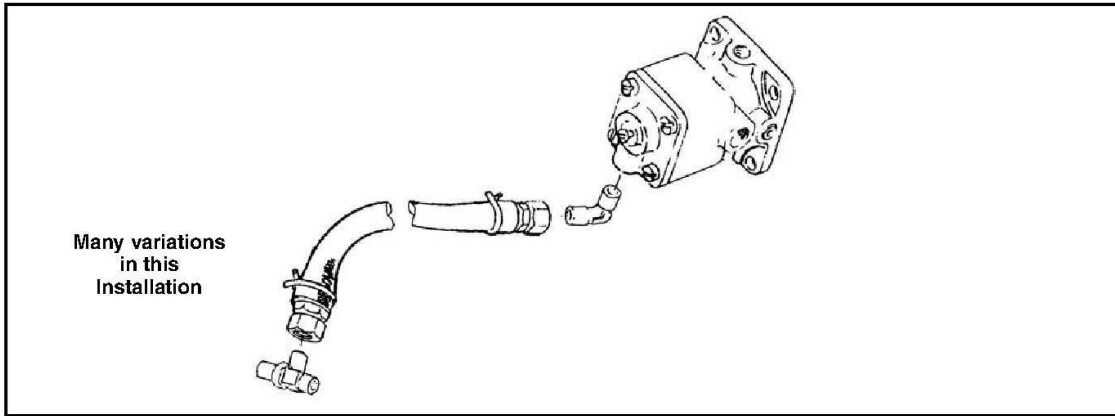

Figure 5 - Typical HET 201F Fuel Pump Plumbed to Upper Deck Reference

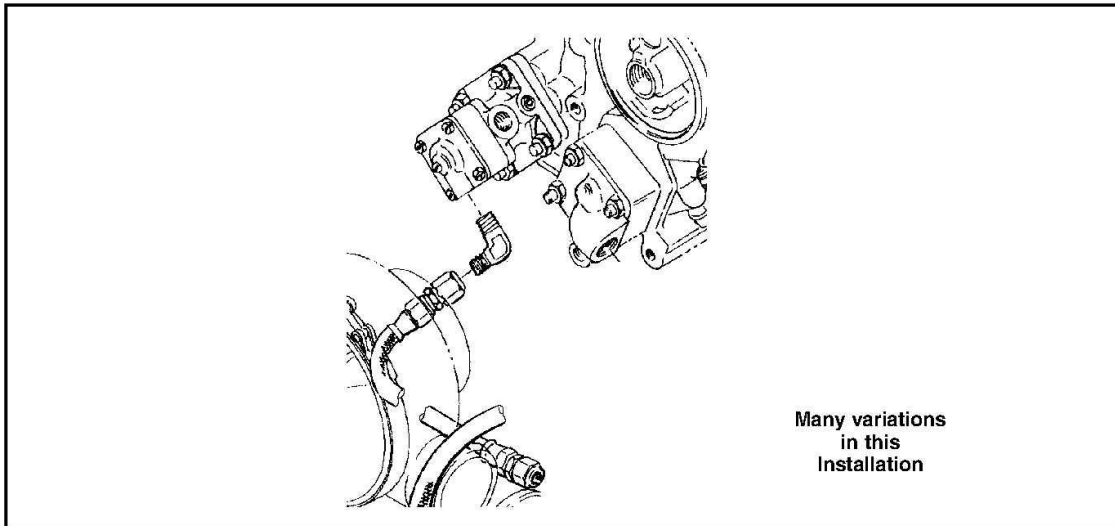

Figure 6 - Typical HET 201F Fuel Pump Turbocharger Reference Line Connection

ISSUED			REVISED			PAGE NO.	REVISION	S.B. 628
MO	DAY	YEAR	MO		YEAR			
08	29	17	--	--	--	21 of 27		

# Alert Service Bulletin

Alert Service Bulletin No. 069

## 200F, 201F, 202F Fuel Pump Leak Inspection and Diaphragm Replacement

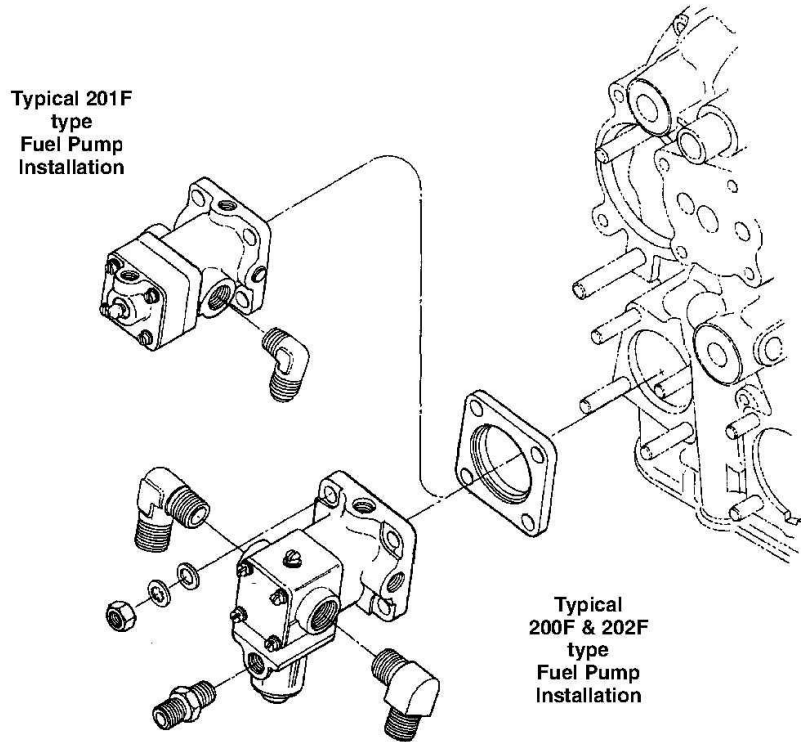

Figure 3 - Typical HET Series Fuel Pumps

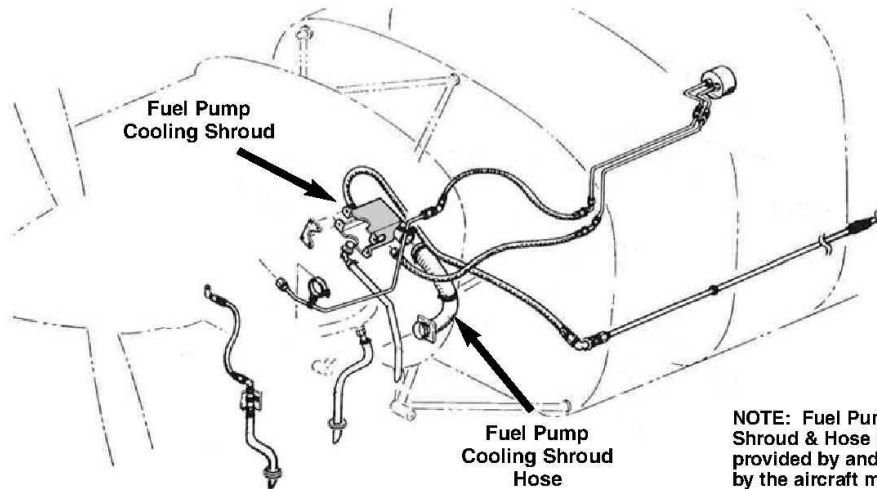

Figure 4 - Typical Cooling Shroud Installation

ISSUED			REVISED			PAGE NO.	REVISION	S.B. 628
MO	DAY	YEAR	MO	DAY	YEAR			
08	29	17	--	--	--	22 of 27		

# Alert Service Bulletin

Alert Service Bulletin No. 069

200F, 201F, 202F Fuel Pump Leak Inspection and Diaphragm Replacement

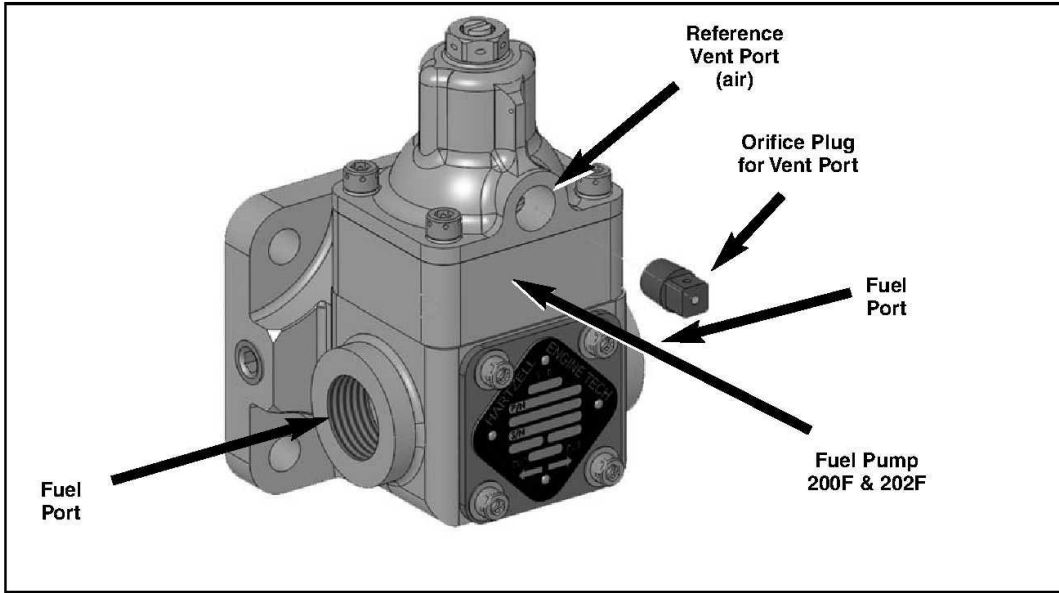

Figure 1 - 200F & 202F Identification

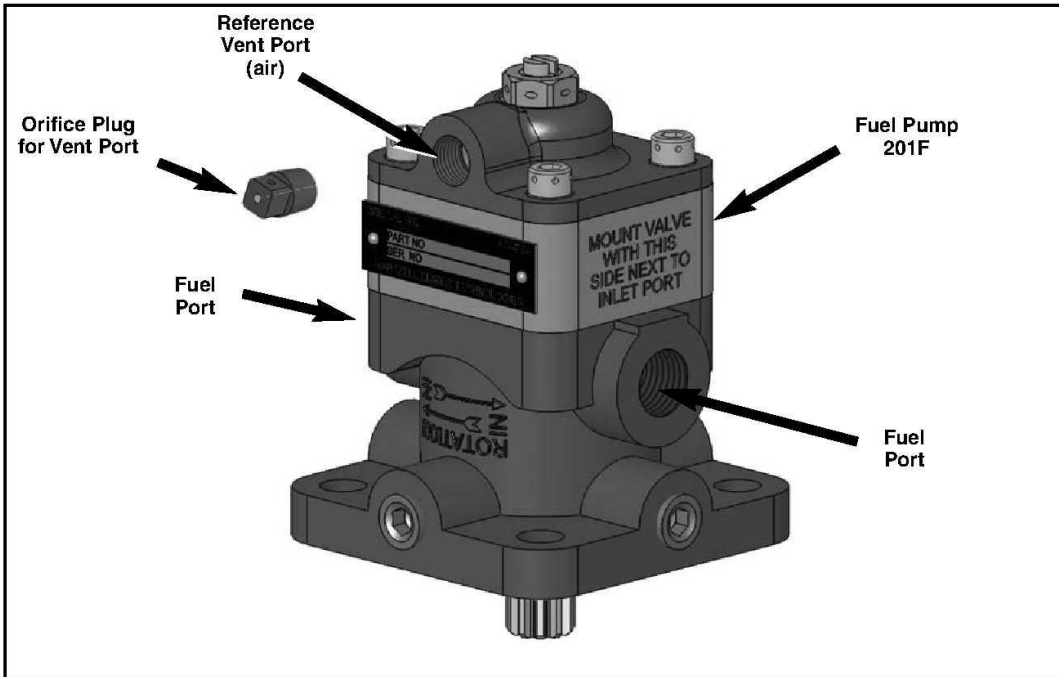

Figure 2 - 201F Identification

Rev. New: January 25/17  
 © 2017 - Hartzell Engine Technologies. - All rights reserved

ASB 069  
 Page 7 of 12

ISSUED			REVISED			PAGE NO.	REVISION	S.B. 628
MO	DAY	YEAR	MO	YEAR				
08	29	17	--	--	--	23 of 27		

# Alert Service Bulletin

## Alert Service Bulletin No. 069

### 200F, 201F, 202F Fuel Pump Leak Inspection and Diaphragm Replacement

#### E. Maintenance Record

- (1) For affected fuel pumps continuing in service, make an engine logbook entry to indicate compliance with this Alert Service Bulletin noting when the next inspection is due.
- (2) For terminating action, make an engine logbook entry to indicate compliance with this Alert Service Bulletin by replacement of the fuel pump with one not affected or repair of an affected fuel pump by replacement of an unaffected diaphragm.

#### 4. Contact Information

##### A. Contact **HET Product Support** for all communications regarding the technical content of this Alert Service Bulletin.

- (1) Phone +1.334.386.5400 (Option 2)
- (2) Fax +1.334.386.5450.
- (3) E-mail at techsupport@HartzellEngineTech.com.
- (4) Address

Hartzell Engine Technologies LLC  
2900 Selma Highway,  
Montgomery, AL 36108  
USA

ISSUED			REVISED			PAGE NO.	REVISION	S.B. 628
MO	DAY	YEAR	MO	DAY	YEAR			
08	29	17	--	--	--	24 of 27		



# Alert Service Bulletin

## Alert Service Bulletin No. 069

### 200F, 201F, 202F Fuel Pump Leak Inspection and Diaphragm Replacement

- (b) Disassemble the applicable fuel pump in accordance with Section 3 of HET P/N 200201-0000 manual as appropriate for the applicable part number and model. Use only those sections required to replace the diaphragm.
- (c) Replace the existing HET P/N 063F-0001 diaphragm with a new diaphragm shipped from HET after December 8, 2016.
- (d) Assemble the fuel pump in accordance with Section 7 of the HET 200201-0000 overhaul manual as appropriate to the model number. Use only those sections required to install the diaphragm. Diaphragm replacement instruction applies to the fuel pump model but is not part number specific.
- (e) Install the four new flat washers HET P/N 065F-0003 and the four new cap screws HET P/N NAS1352C3H20.
- (f) Using a socket with 5/32 inch hex stock inserted and a calibrated torque wrench, torque the new cap screws in a crisscross pattern applying 23-25 in-lbs (2.59-2.82 Nm).
- (g) Test and adjust the applicable fuel pump in accordance with Section 2 of the HET P/N 200201-0000 overhaul manual as appropriate for the applicable part number and model. Use only those sections required to test the fuel pump and adjust the relief valve.
  - 1 For the 200F Fuel Pump P/N 200F-5006 (62E23190) and P/N 200F-5007 (62E23191-Y), the Relief Valve Setting data is shown in the following table.

Model No.	Application	Direction of Rotation	Inlet Pressure (in. HgA)	Speed (rpm)	Flow (pph)	Discharge Pressure (psig)
200F-5006	Lycoming (62E23190)	CW	26 In. HgA	2500 +/-50	265 +/-5	25 - 40 *
			28 In. HgA	650 +/-10	95 +/-5	25 +/-1 *
200F-5007	Lycoming (62E23191-Y)	CCW	26 In. HgA	2575 +/-50	260 +/-5	65 +/-1 *
			28 In. HgA	650 +/-10	9 MIN	36 +/-1 *

\* Relief valve setting requires that two set points be achieved.

- (h) Install 0.032 inch stainless steel safety wire or the optional Safe-T-Cable™, HET P/N RX-1961 at the head of the cap screws. Tool requirements and Installation for Safe-T-Cable™ may be found at <http://www.dmctools.com>.
  - (i) Reinstall the fuel pump and fuel pump cooling shroud with air hose, if removed, in accordance with current engine/airframe maintenance manual or service instructions.
- (3) Fuel Pump Replacement
- (a) Replace the fuel pump with one not affected by this Alert Service Bulletin in accordance with the engine and airframe service instructions and continue to “Return to Service” 3.D.(1).

#### D. Return to Service

- (1) Perform the recommended fuel pump/fuel system set up and functional tests in accordance with the appropriate aircraft maintenance manual, engine service instructions, and operational tests in the AFM or POH.
- (2) Inspect the fuel pump installation for security and leaks.

ISSUED			REVISED			PAGE NO.	REVISION	S.B. 628
MO	DAY	YEAR	MO		YEAR	25 of 27		
08	29	17	--	--	--			

# Alert Service Bulletin

## Alert Service Bulletin No. 069

### 200F, 201F, 202F Fuel Pump Leak Inspection and Diaphragm Replacement

#### B. Fuel Pump Reference Vent Port Inspection

**NOTE:** Some engine applications will have a cooling shroud installed over the fuel pump. It may be necessary to remove this shroud for initial identification and for recurring inspection.

- (1) The HET series fuel pumps use the reference vent port in several ways. The port may have an orifice plug installed, a fitting for an upper deck reference line or a fitting to connect to the engine turbocharger reference.
  - (a) Inspection of the orifice plug requires only a visual inspection. Look around the plug and into the orifice for fuel or blue dye stains. Refer to Fig. 1 or Fig. 2.
  - (b) Inspection of the upper deck reference line requires that the line be disconnected and the inside of the fitting be inspected for fuel or blue dye stains. Refer to Fig. 5 and 6.
  - (c) Inspection of the engine turbocharger reference line will require that the "B" nut be removed and the inside of the fitting be inspected for fuel or blue dye stains.
- (2) Inspection for fuel or blue dye stains may require use of a "Q" tip cotton swab or similar device to check for the presence of fuel or blue dye.
- (3) If fuel or blue dye stains are not found, refer to Compliance 1.E(1)b and continue to Corrective Action 3.C as convenient.
  - (a) Reassemble the connection for the upper deck reference or the engine turbocharger reference lines.
  - (b) If removed, reinstall the fuel pump cooling shroud and air hose (if applicable) in accordance with latest engine/airframe service instructions or maintenance manual and continue to "Return to Service" 3.D.(1). Refer to Fig. 4.
- (4) If fuel or blue dye stains are found, continue to "Corrective Action" 3.C.

#### C. Corrective Action - Choose (1), (2), or (3):

- (1) Fuel Pump Factory Repair
  - (a) Remove fuel pump and cooling shroud (if required), from engine in accordance with engine and airframe service instructions. Retain all engine or aircraft supplied fittings from the fuel pump prior to return. **(HET cannot return fittings to the customer.)**
  - (b) Forward the affected fuel pump to the HET factory per the instructions contained in Appendix I-Commercial Assistance found at the end of this Alert Service Bulletin.
  - (c) Install the repaired fuel pump on the engine along with the cooling shroud (if required) in accordance with current engine/airframe service instructions or maintenance manual and continue to "Return to Service" 3.D.(1).
- (2) Fuel Pump Field Repair:

**NOTE 1:** Refer to the HET overhaul manual P/N 200201-0000 Rev. H or latest revision for the following steps necessary to replace the diaphragm in the applicable model and part number fuel pump.

**NOTE 2:** Fuel Pump P/N 200F-5006 (Lycoming P/N 62E23190) and P/N 200F-5007 (Lycoming P/N 62E23191-Y) are not listed in the current overhaul manual, however, the HET overhaul manual P/N 200201-0000 Rev. H or later may be used along with these instructions.

- (a) Remove fuel pump and cooling shroud (if required), from engine in accordance with engine and airframe service instructions.

ISSUED			REVISED			PAGE NO.	REVISION	S.B. 628
MO	DAY	YEAR	MO	DAY	YEAR			
08	29	17	--	--	--	26 of 27		

# Alert Service Bulletin Appendix

Alert Service Bulletin No. 069

200F, 201F, 202F Fuel Pump Leak Inspection and Diaphragm Replacement

## ASB 069 CLAIM FORM

### Owner information

Name: \_\_\_\_\_ Date: \_\_\_\_\_ Tel: \_\_\_\_\_ Fax: \_\_\_\_\_

Company Name: \_\_\_\_\_ E-mail: \_\_\_\_\_

Address: \_\_\_\_\_

City: \_\_\_\_\_ State: \_\_\_\_\_ Postal Code: \_\_\_\_\_

Country: \_\_\_\_\_

### Aircraft/Engine Service Facility information

Name: \_\_\_\_\_ Date: \_\_\_\_\_ Tel: \_\_\_\_\_ Fax: \_\_\_\_\_

Company Name: \_\_\_\_\_ E-mail: \_\_\_\_\_

Address: \_\_\_\_\_

City: \_\_\_\_\_ State: \_\_\_\_\_ Postal Code: \_\_\_\_\_

Country: \_\_\_\_\_

Aircraft Mfg: \_\_\_\_\_ Model: \_\_\_\_\_ Time in Service: \_\_\_\_\_ S/N: \_\_\_\_\_

Engine: \_\_\_\_\_ Model: \_\_\_\_\_ Time in Service: \_\_\_\_\_ S/N: \_\_\_\_\_

### Payment Information

Same as Owner:  Same as Facility:  Other  \_\_\_\_\_ Name  
\_\_\_\_\_ Address

### Component Information

Nomenclature: \_\_\_\_\_ Part Number: \_\_\_\_\_

Serial Number: \_\_\_\_\_ (Fuel Pump) Date Removed: \_\_\_\_\_

Part Time in Service: \_\_\_\_\_ (Fuel Pump) Original Date Installed: \_\_\_\_\_

For RMA Number

Send this ASB 069 Claim Form to:

Hartzell Engine Technologies Product Support

Fax: +1.334.386.5450

E-mail: techsupport@hartzellenginetech.com

### RMA Number:

(write in HET assigned RMA number)

**Hartzell Use Only - do not write below this line.**

Warranty No: \_\_\_\_\_ Authorized by: \_\_\_\_\_

© 2017 - Hartzell Engine Technologies. - All rights reserved

Appendix page 4 of 4

ISSUED			REVISED			PAGE NO.	REVISION	S.B. 628
MO	DAY	YEAR	MO		YEAR			
08	29	17	--	--	--	27 of 27		